

Title Number : SY767771

This title is dealt with by Land Registry, Durham Office.

The following extract contains information taken from the register of the above title number. A full copy of the register accompanies this document and you should read that in order to be sure that these brief details are complete.

Neither this extract nor the full copy is an 'Official Copy' of the register. An official copy of the register is admissible in evidence in a court to the same extent as the original. A person is entitled to be indemnified by the registrar if he or she suffers loss by reason of a mistake in an official copy.

This extract shows information current on 24 NOV 2014 at 09:16:07 and so does not take account of any application made after that time even if pending in the Land Registry when this extract was issued.

REGISTER EXTRACT

Title Number	: SY767771
Address of Property	: Paddock 5, Rose Lane, Ripley, Woking
Price Stated	: £38,000
Registered Owner(s)	: ALEXANDER DUDLEY STEWART-CLARK of 15 Ivory House, Plantation Wharf, London SW11 3TN.
Lender(s)	: None

Title number SY767771

This is a copy of the register of the title number set out immediately below, showing the entries in the register on 24 NOV 2014 at 09:16:07. This copy does not take account of any application made after that time even if still pending in the Land Registry when this copy was issued.

This copy is not an 'Official Copy' of the register. An official copy of the register is admissible in evidence in a court to the same extent as the original. A person is entitled to be indemnified by the registrar if he or she suffers loss by reason of a mistake in an official copy. If you want to obtain an official copy, the Land Registry web site explains how to do this.

A: Property Register

This register describes the land and estate comprised in the title.

SURREY : GUILDFORD

- 1 (21.01.1959) The Freehold land shown edged with red on the plan of the above title filed at the Registry and being Paddock 5, Rose Lane, Ripley, Woking.
- 2 A Transfer dated 26 April 1961 made between (1) Gordon Kirwan Kirwan-Taylor and Stuart John Twentymen Turnbull and (2) Ashdale Land and Property Company Limited is expressed to grant the following rights:-

"There are expressly included in this transfer as appurtenant to the land comprised therein All rights of way water drainage support and other rights of a similar nature as have existed or have been enjoyed heretofore as quasi-easements or rights in the nature of easements for the benefit of the said land over the adjoining or adjacent parts of the Ockham Park Estate"
- 3 (21.11.2007) The land has the benefit of the rights granted by but is subject to the rights reserved by the Transfer dated 13 November 2007 referred to in the Charges Register.

B: Proprietorship Register

This register specifies the class of title and identifies the owner. It contains any entries that affect the right of disposal.

Title absolute

- 1 (21.11.2007) PROPRIETOR: ALEXANDER DUDLEY STEWART-CLARK of 15 Ivory House, Plantation Wharf, London SW11 3TN.
- 2 (21.11.2007) The price stated to have been paid on 13 November 2007 was £38,000.
- 3 (21.11.2007) RESTRICTION: No disposition of the registered estate (other than a charge) by the proprietor of the registered estate is to be registered without a certificate signed by the proprietor for the time being of the estate registered under title number SY720718 or if appropriate signed on such proprietors behalf by its conveyancer that the provisions of clause 13.4.3 of the Transfer dated 13 November 2007 have been complied with.

C: Charges Register

This register contains any charges and other matters that affect the land.

- 1 (14.07.1995) A Transfer of the land in this title and other land dated 5 May 1995 made between (1) Ashdale Land and Property Company Limited and (2) Stephen Chitty and Elizabeth Chitty contains restrictive covenants.

NOTE: Original filed under SY653801.

Title number SY767771

C: Charges Register continued

2 (21.11.2007) A Transfer of the land in this title dated 13 November 2007 made between (1) Mark Randolph Dyer and (2) Alexander Dudley Stewart-Clark contains restrictive covenants.

NOTE: Copy filed.

End of register

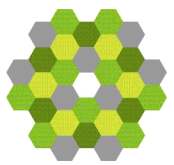

©Crown Copyright. Produced by Land Registry. Reproduction in whole or in part is prohibited without the prior written permission of Ordnance Survey. Licence Number 100026316.

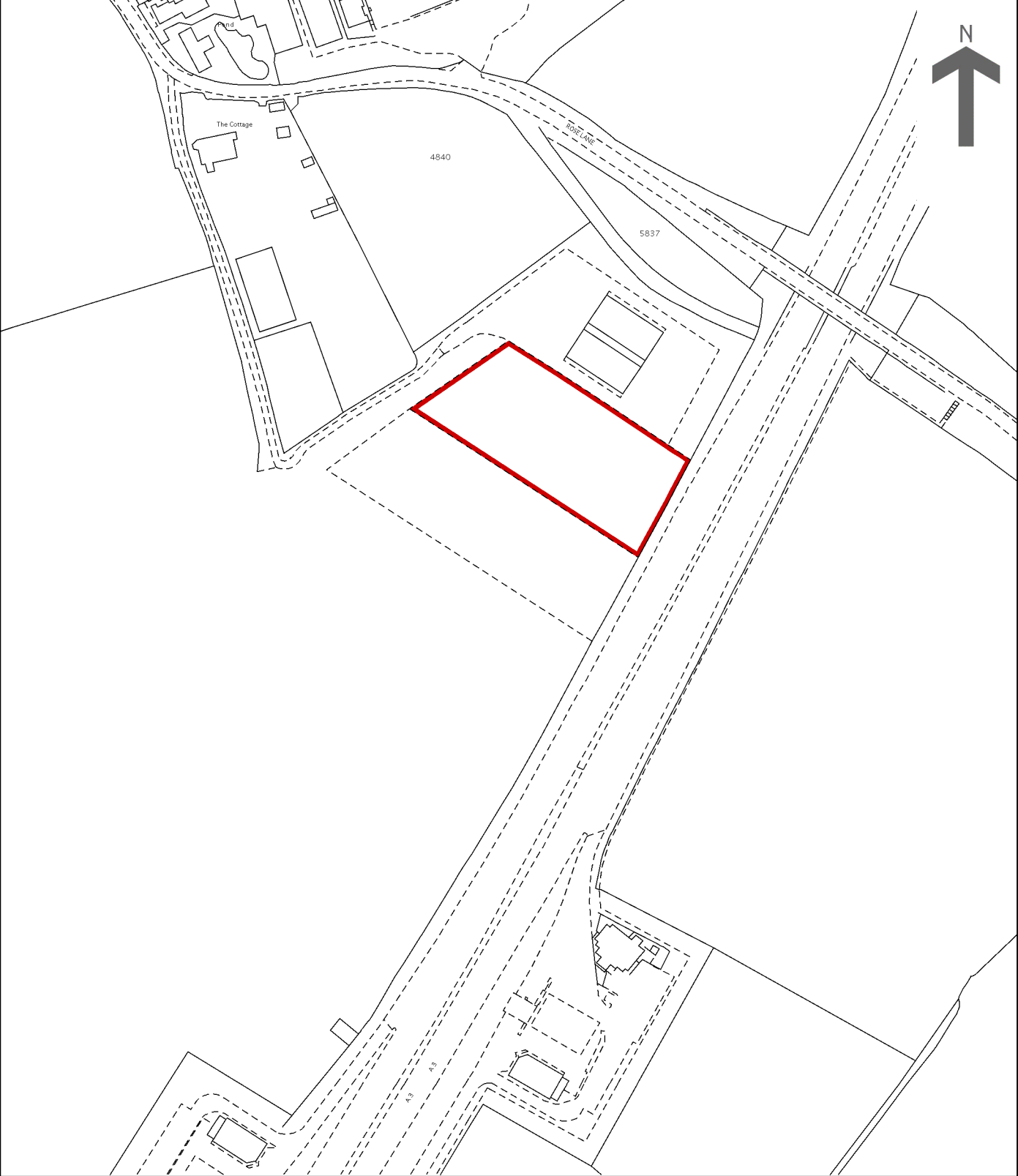

This is a copy of the title plan on 24 NOV 2014 at 09:16:07. This copy does not take account of any application made after that time even if still pending in the Land Registry when this copy was issued.

This copy is not an 'Official Copy' of the title plan. An official copy of the title plan is admissible in evidence in a court to the same extent as the original. A person is entitled to be indemnified by the registrar if he or she suffers loss by reason of a mistake in an official copy. If you want to obtain an official copy, the Land Registry web site explains how to do this.

The Land Registry endeavours to maintain high quality and scale accuracy of title plan images. The quality and accuracy of any print will depend on your printer, your computer and its print settings. This title plan shows the general position, not the exact line, of the boundaries. It may be subject to distortions in scale. Measurements scaled from this plan may not match measurements between the same points on the ground.

This title is dealt with by Land Registry, Durham Office.